

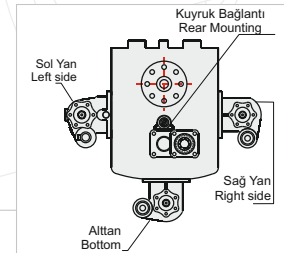

50211321 + 60216151

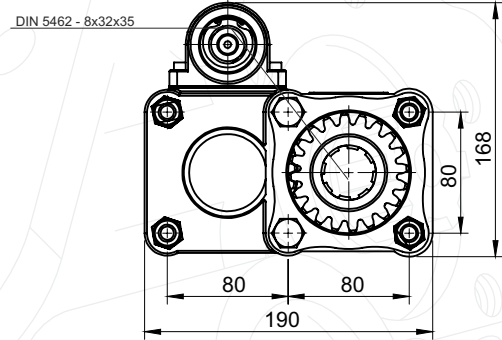
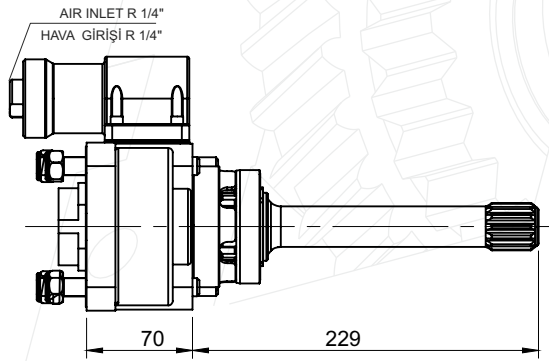
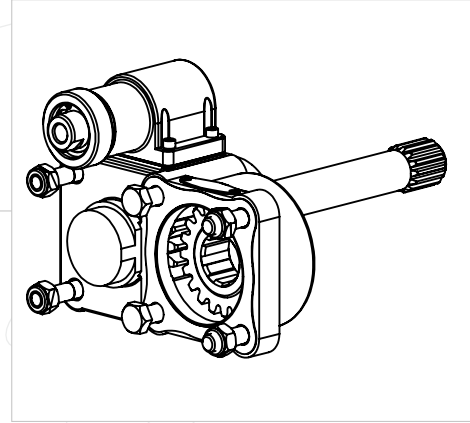
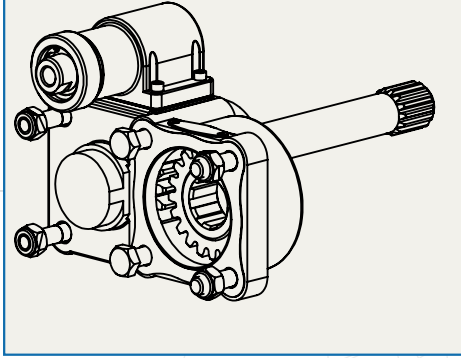

**GENEL BİLGİLER/GENERAL DATA**

P.T.O. KODU / P.T.O. CODE	50211321 + 60216151	
Tork / Torque	26,5 Kgm	260 Nm
Güç(1000 rpm) / Power	24,5 Hp	18,3 Kw
Devir / Speed	675 rpm	675 rpm
Oran / Ratio	1/1,2	1/1,2
Ağırlık / Weight	13 kg	
Bağlantı / Mounting	Kuyruk	Rear
Kumanda / Control	Havali	Pneumatic
Dönüş / P.T.O. Rotation	Sol - ISO	Left - ISO

Ana Şanzıman / Gearbox	Kullanılan Bazı Araçlar / Used Vehicles
ZF ECOMID 16 S 109 (13,53-11,86) (B.288) / 8 S 109 (13,53) / 9 S 109 (10,24-10,25) (650 rpm,SOL)	17.232-19.230-19.340-26.342 MAN / 2530-3226 FORD CARGO / RENAULT PREMIUM 320.32-370 AS19.300 -26.300 32.300-38.300 HI-EX FARGO ASKAM / ISUZU FTR 800-FVR 900-FTM 1200 -FVZ 1700 75.300 DAF / STEYR

Seçeceğiniz pompanın dönüş yönü, P.T.O. dönüş yönü ile ters olmalıdır.  
The rotation of the choosen pump has to be opposite with the rotation of P.T.O.

P.T.O. montaj edildikten sonra ana şanzıman yağını tamamlayın.  
Fill the oil of the gear box after mounting the P.T.O.

POWER TAKE OFF

P.T.O.