

50610512M0

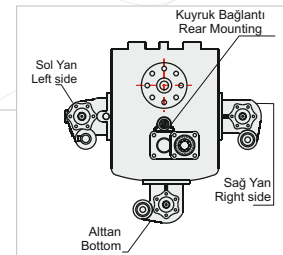
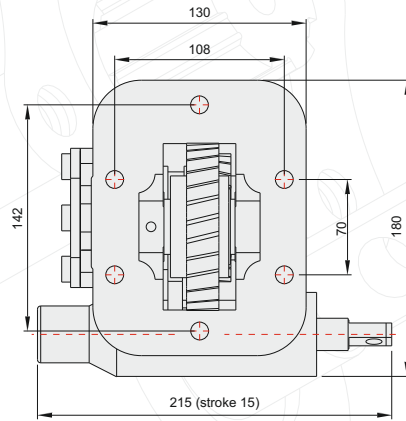
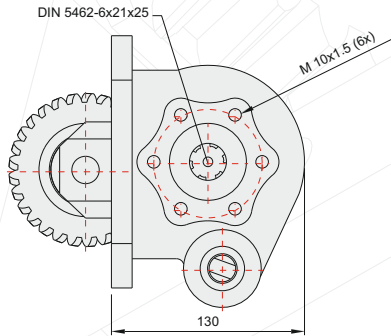
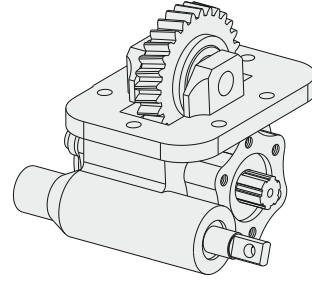
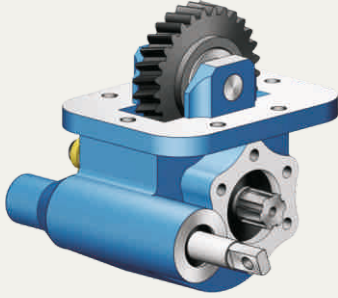

GENEL BİLGİLER/GENERAL DATA

P.T.O. KODU / P.T.O. CODE	50610512M0	
Tork / Torque	16,6 Kgm	162,8 Nm
Güç(1000 rpm) / Power	14,2 Hp	10,6 Kw
Devir / Speed	600rpm	600 rpm
Oran / Ratio	1/1,34	1/1,34
Ağırlık / Weight	11 kg	24,3 lb
Bağlantı / Mounting	Sol	Left
Kumanda / Control	Mekanik	Mechanic
Dönüş / P.T.O. Rotation	Sağ - UNI	Right - UNI

Ana Şanzıman / Gearbox	Kullanılan Bazı Araçlar / Used Vehicles
MSB-5S / MSB-5M / MSB-5G / MOA-89 / MSB-5R	NKR 2.8 ISUZU LOW / NKR 55 LOW NHR 55E / CARRIER 250T

Seçeğinizin pompanın dönüş yönü, P.T.O. dönüş yönü ile ters olmalıdır.
The rotation of the choosen pump has to be opposite with the rotation of P.T.O.

P.T.O. montaj edildikten sonra ana şanzıman yağını tamamlayın.
Fill the oil of the gear box after mounting the P.T.O.