

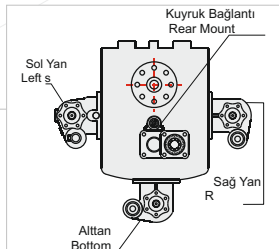

50611512M0

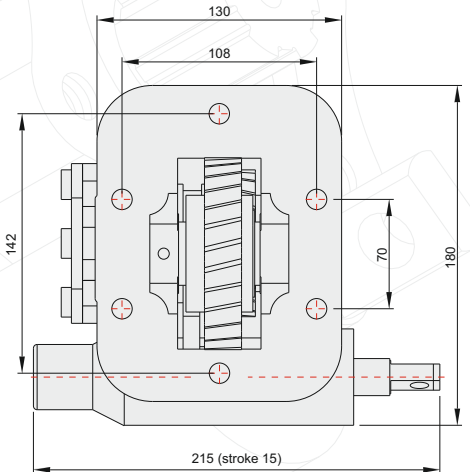
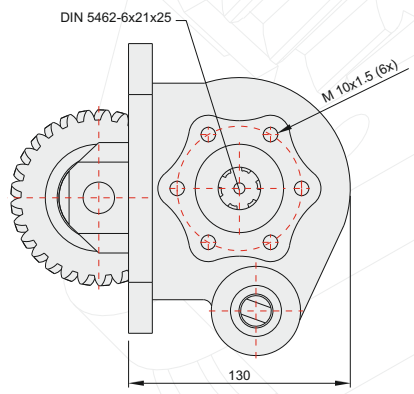
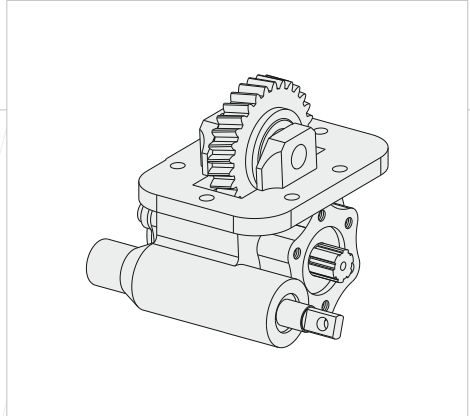

GENEL BİLGİLER/GENERAL DATA

P.T.O. KODU / P.T.O. CODE	50611512M0	
Tork / Torque	18,2 Kgm	178,5 Nm
Güç(1000 rpm) / Power	15 Hp	11,2 Kw
Dev Speed	600rpm	600 rpm
Oran / Rat	1/1,31	1/1,31
Ağırlık / We	11 kg	24,3 lb
Bağlantı / Mount	Sol	Left
Kumanda / Control	Mekan	
Dönüş / P.T.O. Rotat	Sağ - UNI	R

Ana Şanzıman / Gearbox
MSA-5P/ MSA-5G / SMA-SP / MSA-5D

Kullanılan Bazı Araçlar / Used Veh
KS11-KS 20-KS 32-8.8 WIDE DIESEL- NKR 55 L / 3.3 IRAN ISUZU NKR-NHR- HPR 3.6 / 3.9 ISUZU - JAC HVC SAH 1063 (LC 5 T 30)

POWER TAKE OFF

P.T.O.