

50319522P0

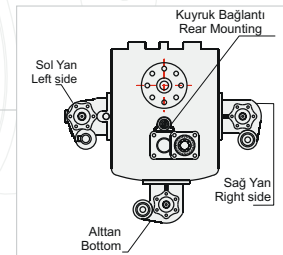
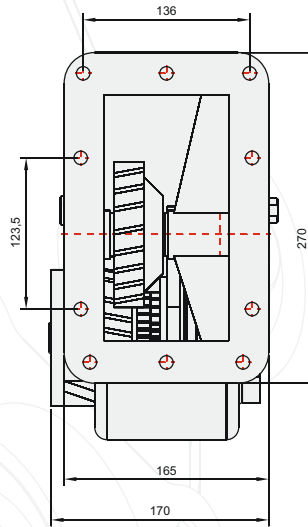
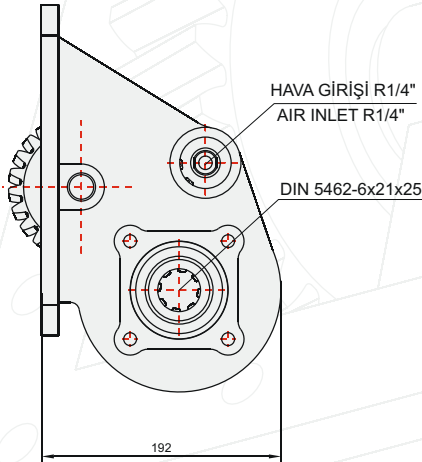
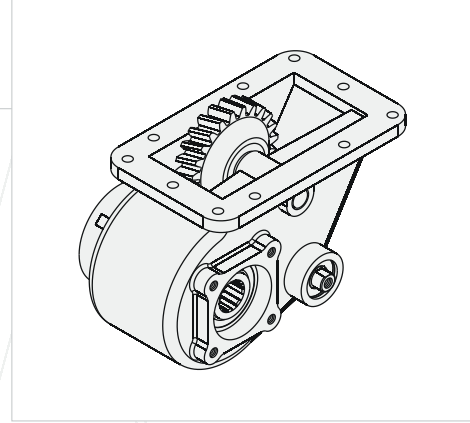

GENEL BİLGİLER/GENERAL DATA

P.T.O. KODU / P.T.O. CODE	50319522P0	
Tork / Torque	29 Kgm	284 Nm
Güç(1000 rpm) / Power	37,5 Hp	27,6 Kw
Devir / Speed	1000 rpm	1000 rpm
Oran / Ratio	1/0,78	1/0,78
Ağırlık / Weight	22,5 kg	49,6 lb
Bağlantı / Mounting	Sağ yan	Right side
Kumanda / Control	Havali	Pneumatic
Dönüş / P.T.O. Rotation	Sağ - ISO	Right- ISO

Seçeğinizin pompanın dönüş yönü, P.T.O. dönüş yönü ile ters olmalıdır.
The rotation of the choosen pump has to be opposite with the rotation of P.T.O.

Ana Şanzıman / Gearbox	Kullanılan Bazı Araçlar / Used Vehicles
GS 770 - GS 771 - G 670 - GS 750 GS 760 SCANIA	93-100H-111-112-113R-143P-82 H220-93 HG 230 SCANIA

P.T.O. montaj edildikten sonra ana şanzıman yağını tamamlayın.
Fill the oil of the gear box after mounting the P.T.O.